

GENERAL NOTES

THIS DRAWING TO BE READ IN CONJUNCTION WITH ARCHITECT'S DRAWINGS, CONSULTANT ENGINEER'S DRAWINGS AND SPECIFICATIONS & LANDSCAPE ARCHITECT'S DRAWINGS.
REFER TO ARCHITECT'S SITE PLAN PL02 FOR NORTH ORIENTATION.
LEVELS GIVEN ON HOUSE TYPE DRAWINGS ARE GIVEN TO A LOCAL ABSOLUTE ZERO LEVEL. FOR SPECIFIC LEVELS DEPENDING ON INDIVIDUAL UNIT LOCATION, REFER TO ARCHITECT'S CONTEXT SECTIONS AND ENGINEER'S DRAWINGS WHERE LEVELS ARE ALL GIVEN IN RELATION TO LAND SURVEYOR'S BENCHMARK BASED ON MALIN HEAD DATUM LEVEL.

NOTES ON FINISHES:

ROOF: TO BE FINISHED IN SLATE OR CONCRETE ROOF TILES IN SELECTED COLOUR OR SIMILAR APPROVED.
WALLS: SELECTED CLAY BRICKWORK WHERE INDICATED OTHERWISE PAINTED SAND / CEMENT RENDER OR SELF COLOURED RENDER. EXPRESSED SANDS AROUND EXTERNAL OPENINGS. EXPRESSED LINTELS OVER EXTERNAL OPENINGS WHERE INDICATED TO BE RECONSTITUTED STONE (LIGHT CREAM LIMESTONE OR GRANITE EFFECT).
JOINERY: ALL WINDOWS AND DOORS, FRAMES AND LEAVES, TO BE ALUMINIUM POWDER COATED TO APPROVED COLOUR OR UPVC OR PAINTED TIMBER TO APPROVED COLOUR. DISCRETE GLAZING WHERE INDICATED TO SENSITIVE WINDOWS.

RAINWATER GOODS: GUTTERS, DOWNPIPES, AND FIXINGS TO BE UPVC OR ALUMINIUM POWDER COATED TO SELECTED COLOUR TO MATCH ROOF SLATES.

* SOLAR PANELS: INDICATIVE SOLAR PANEL POSITION. FINAL SOLAR PANEL POSITION DEPENDS ON HOUSE ORIENTATION. THE SOLAR PANELS SHOWN ARE A PROVISIONAL OPTION TO SATISFY RENEWABLE ENERGY REQUIREMENTS OF BUILDING REGS PART 1. SOLAR PANELS MAY BE OMITTED IN FAVOUR OF ALTERNATIVE RENEWABLE ENERGY SOURCE.

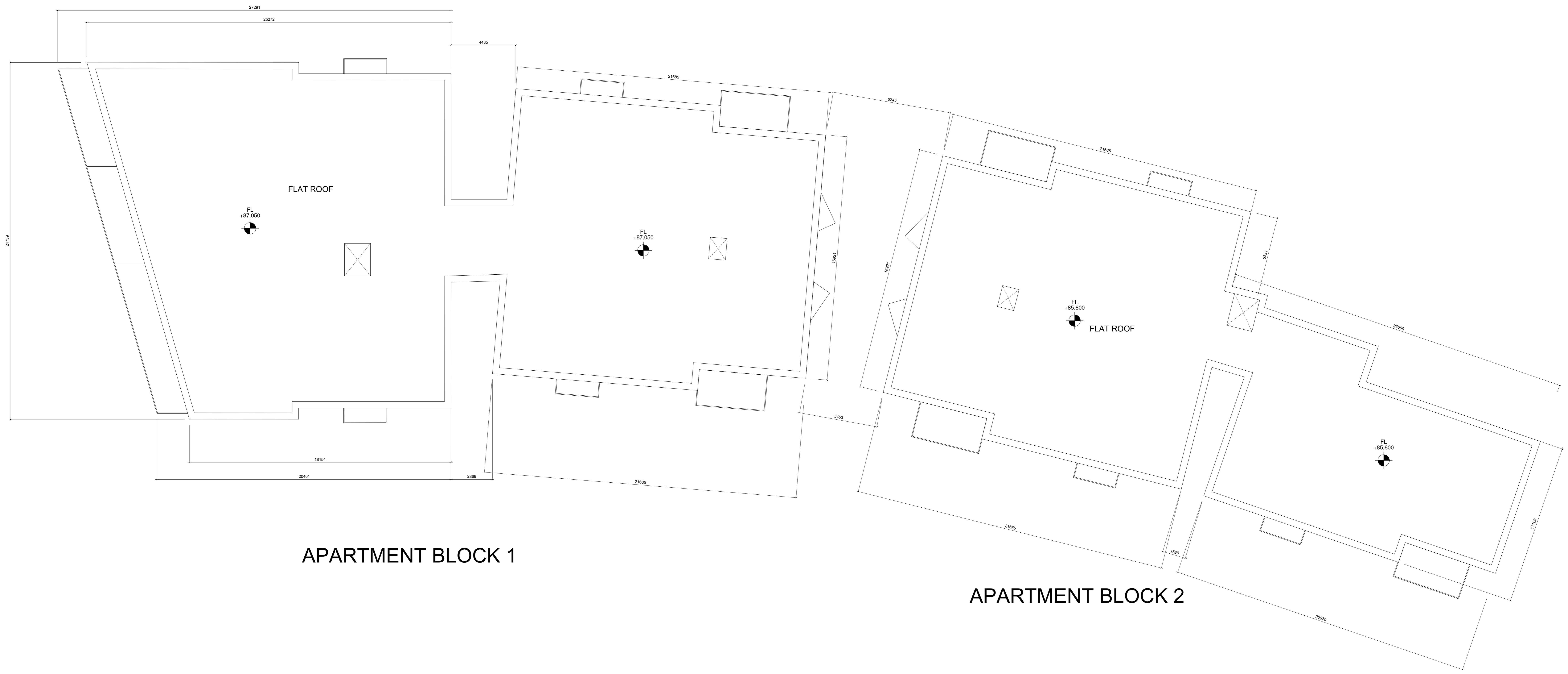

APARTMENT BLOCK 1

APARTMENT BLOCK 2

NOTES:

DO NOT SCALE FROM DRAWINGS WORK TO FIGURED DIMENSIONS ONLY. ARCHITECT TO BE NOTIFIED OF ALL DISCREPANCIES.

REVISIONS		No.
DATE	DESCRIPTION	

	Capdoo, Clane Apartment Blocks 01 and 02 Ref Plan	DATE: Feb 2019 SCALE: 1:100 DRAWING NO: 16016 PL58	PROJECT: Capdoo, Clane ARCHITECT: PMcN DRAWING NO: 16016 PL58
	<small> 10 Crossbar Grove, Malinbeg, Co. Tyrone, N.I. Tel: 01 438 2020 Fax: 01 438 2021 Email: info@mcorm.com </small>	<small> 10 Crossbar Grove, Malinbeg, Co. Tyrone, N.I. Tel: 01 438 2020 Fax: 01 438 2021 Email: info@mcorm.com </small>	<small> 10 Crossbar Grove, Malinbeg, Co. Tyrone, N.I. Tel: 01 438 2020 Fax: 01 438 2021 Email: info@mcorm.com </small>